

Elements

- 3x 700mm aluminium upright sections (2x female & male plugs, 1x male plug & light cap)
- 1x Base
- 1x Travel Twi:st Graphic

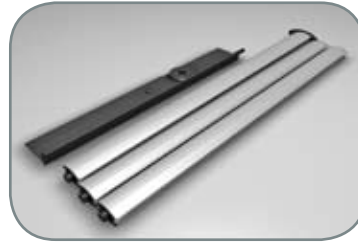

The Travel Twi:st banner is extremely simple and quick to erect.

Open base to 90 degree angle and place on floor as shown.

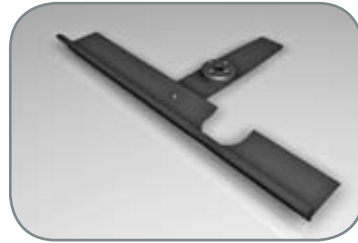

Build the upright by twisting the bottom section onto the base, then middle section, then top section (with light cap).

Holding the top of the graphic, place the tensioning bar in the groove on the light cap at the front of the Travel Twi:st and allow the graphic to hang. Gently pull downwards on the bottom of the graphic and hook under the front of the base as shown. Move the tensioning bar so it sits central on the caps groove.

Do not move the banner by holding the upright in a horizontal position.

Your banner is now finished.

If you have chosen to have a light; take the light and plug into holes situated on top of the cap. **Please take care when adjusting the light and only move it by holding the black moulded handle – not the light itself.** Next, take your transformer and plug the two jack plugs into the side sockets on the cap. [Within the extrusion design there is a channel for the cable where needed]. Plug transformer into mains.

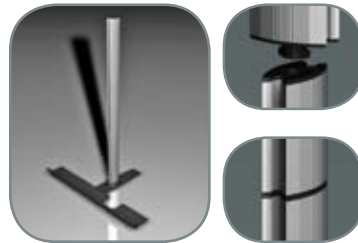

Troubleshooting:

The black tensioning bar pops off

Possible cause:

The graphic has been cut too short. Please check your graphic is cut to the appropriate length:

3x 700 sections = 2060mm graphic length

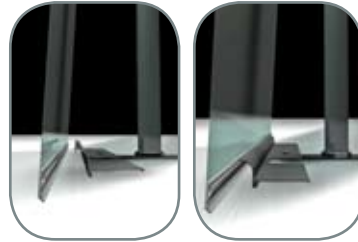

The light wont fit in it's socket or won't work:

Possible causes.

The light is being put into the wrong holes: please ensure you are pushing the light into the front or rear of the light cap and not from the side.

Initial application may prove slightly stiff, please ensure you are pressing hard enough.

The transformer is not plugged in. Please ensure the transformer jack plugs are plugged into the holes on the side of the light cap, and that it is plugged into a live mains socket.

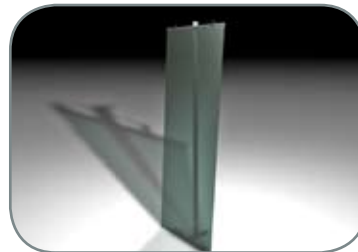

SETUP INSTRUCTIONS ◀

Original Twi:st Banner

Easi-link

Flexi link

Travel Twi:st Banner

Literature Dispenser

Leaflet/Monitor/Laptop Extension

exhibiting with a twist

Elements

- 3x 700mm aluminium upright sections (1x female plug, 1x female & male plugs, 1x male plug & light cap)
- 1x Base (including rubber grommet)
- 1x Light
- 1x Transformer
- 1x Original TwiSt Graphic

The Original TwiSt banner takes approximately 90 seconds to erect including light and graphic.

Place base correct way up as illustrated. Take bottom section of upright and push firmly into black base fitting. (The bottom section has one open end). **Please ensure that the bottom section is pushed fully into the base fitting.**

Continue to build the upright by twisting the middle section onto the bottom, then twisting top section onto the middle. If you prefer, before placing the top section onto the upright you can plug the light into the top holes of the cap, however this can be done at any stage of assembly.

Holding the top of the graphic, place the tensioning strip on the groove in the light cap, then place the two locating pins situated on the bottom mounting strip and slide into place; if needed insert rubber grommet to hold in place. Move the tensioning strip so it sits central on the caps groove.

Do not move the banner by holding the upright in a horizontal position.

If you have not fitted your light already, take the light and plug into holes situated on top of the cap. **Please take care when adjusting the light and only move it by holding the black moulded handle – not the light itself.**

Next, take your transformer and plug the two jack plugs into the side sockets on the cap. [Within the extrusion design there is a channel for the cable where needed]. Plug transformer into mains.

Your banner is now finished.

Troubleshooting:

The black tensioning bar pops off

Possible causes:

The base section is not pushed in far enough. Please ensure this is pushed firmly into the base - initial use of the stand may prove to be stiff.

The graphic has been cut too short. Please check your graphic is cut to the appropriate length:

3x 700 sections = 2000mm graphic length

3x 700 sections, 1x 300mm height extension = 2305mm graphic length

4 x 700 sections = 2705mm graphic length

The light won't fit in its socket or won't work:

Possible causes:

The light is being put into the wrong holes: please ensure you are pushing the light into the front or rear of the light cap and not from the side.

Initial application may prove slightly stiff, please ensure you are pressing hard enough.

The transformer is not plugged in. Please ensure the transformer jack plugs are plugged into the holes on the side of the light cap, and that it is plugged into a live mains socket.

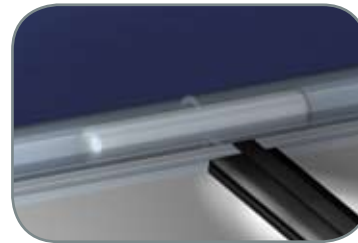
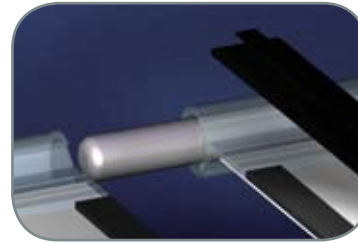
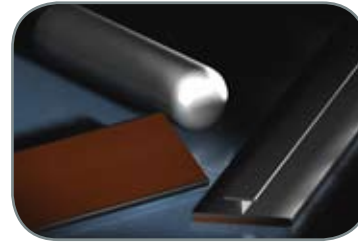

Elements

- 3x Magnetic Bars

2x Metal Pins (Located in zipped pocket in banner hardware bag)

Set up your Original TwiSt banners as normal (your graphics should have already been prepared with magnetic tape (Polarity A) running vertically down linking sides by your print house). Place a rubber grommet in the key hole section on the base of your Original TwiSt banner to hold the locating pin of your graphic in place. Repeat this with the other banner bases.

Place your Original TwiSt banners close together. Take the two linking pins and place in the header and footer strips of one banner.

Next move the Original TwiSt banner without the linking pins into place, then push together fully.

Take one of the floating magnetic bars and simply magnetise to the bottom of the tape already applied to your graphics. Repeat this with the remaining floating magnetic bars going from bottom to top.

Finally, if needed, adjust your graphics so there is a seamless appearance.

Repeat as necessary.



Set up your Original TwiSt banners as normal (your graphics should have already been prepared with magnetic tape (Polarity A) running vertically down linking sides by your print house). Place a rubber grommet in the key hole section on the base of your Original TwiSt banner to hold the locating pin of your graphic in place. Repeat this with the other banner bases.

Place the Original TwiSt banner stands approx 550mm apart (width of Flexi link) in a straight line.

Place the top extruding spring of your Flexi link graphic into each Original TwiSt banner stand hanger. Carefully release your hold of the Flexi link graphic and place the bottom extruding springs into the footer strips.

Take one of the floating magnetic bars and simply magnetise to the bottom of the tape already applied to your graphics. Repeat this, going upward, with the remaining floating magnetic bars.

Finally, if needed, adjust your graphics so there is a seamless appearance.

Repeat as necessary and then move to your desired configuration.